

## Best Practices For the Immersion Blender Bell Attachment

The purpose of this guide is to provide essential safety practices and best techniques for properly attaching and removing the bell on an immersion blender with a blender attachment, ensuring both safe and effective use during food preparation.

**Note:** Before attaching or removing any parts, unplug the blender.

## Attaching the bell and tube

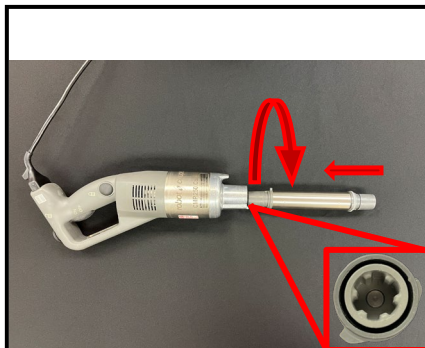
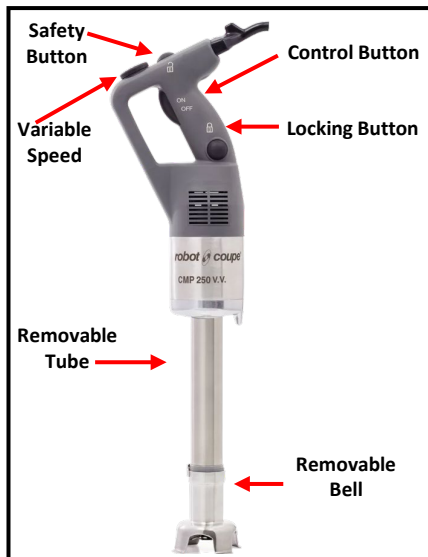

### Diagram of connecting piece

**Step 1:** Connect the tube to the motor unit by inserting the tube and turning counterclockwise.

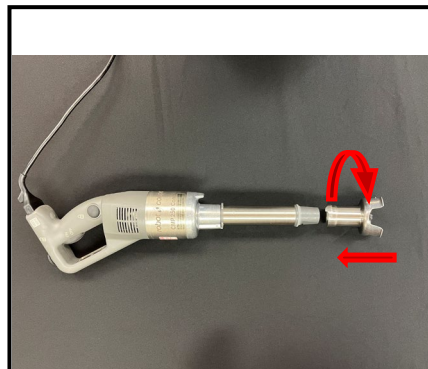

**Step 2:** Insert the Bell into the tube, turning counterclockwise.

## Detaching the bell and tube

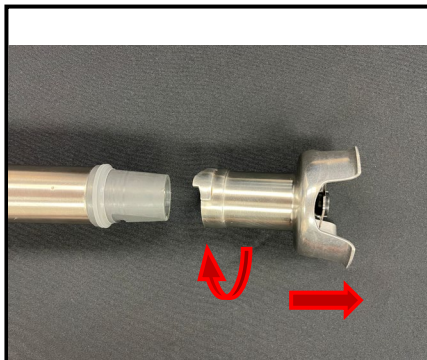

**To disassemble, step 1:** Turn the bell clockwise and pull out

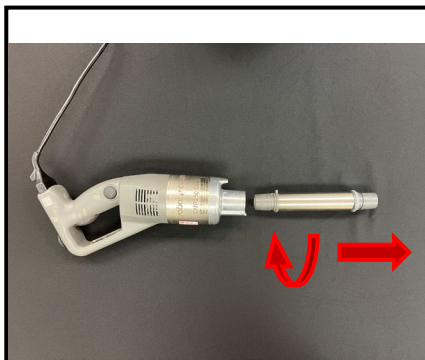

**Step 2:** Turn the tube clockwise to separate the tube from the motor.



For videos and more information visit [www.lausd.org](http://www.lausd.org) > Food Services Resources > Equipment > Immersion Blender